



FATRACLICK

FLOATING VINYL FLOOR

FATRACLICK installation manual

fatra

Fatra, a.s., tř. T. Bati 1541, 763 61 Napajedla, Czech Republic

Tel.: +420 577 501 111, e-mail: podlahy@fatra.cz, www.fatrafloor.cz, www.fatra.cz

FATRACLICK

FLOATING VINYL FLOOR

New Product of Fatra

TOP DESIGN + EUROPEAN QUALITY = FATRACLICK

The vinyl floating floor inherently combines innovations in flooring design, substantial experiences of Fatra experts, and modern interior design trends. The luxury product of a new generation –FatraClick – has arisen from this connection.



- 1 PUR protective layer
- 2 Vinyl design layer
- 3 HDF layer with an increased moisture resistance
- 4 Uniclic® system for an easy and quick installation
- 5 Cork layer ensuring acoustic and thermal insulation

BENEFITS OF THE NEW FATRACLICK VINYL FLOATING FLOOR

- Perfect wood-imitating design
- Quick and easy glueless laying
- Excellent thermal and acoustic insulation
- Antibacterial finish
- Possible laying on under-floor heating
- Proprietary Uniclic® locking system
- Increased resistance against pollution and common chemicals
- Long life time and high walking comfort
- 10-year warranty

www.fatrafloor.cz



Easy installation



No glue



Noise reduction



Thermal comfort



10 Years warranty

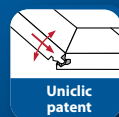

Uniclic patent



Luxury design



Office home



Floor heating



Chair resistance



Anti slip



Easy clean



Recyclable

ISO 9001
ISO 14001
BUREAU VERITAS
Certification



Application

1.	Introduction	2
2.	Installation methods	2
2.1	Method A	2
2.2	Method B	2
3.	Tools for installing the floor	3
4.	FATRACLICK ground rules	3
5.	Preparing the floor panels	4
6.	Preparing the room	4
7.	Protection against moisture	5
8.	Installing the floor	5
8.1	Floor area	5
8.2	Around pipes	7
8.3	Under doorframes	8
8.4	Finishing	8
8.5	Installation on an underfloor heating system	8
9.	Care and maintenance	9

1. Introduction

This manual describes how to install, take care of and maintain the FATRACLICK floor.

FATRACLICK is a vinyl multi-layered floating floor. It is manufactured in panels sized 915 mm x 305 mm and features the Uniclic® lock system for easy installation. Uniclic® is a system for installing laminate floors without using glue. The panels can be clicked together simply thanks to the ingenious shape of the tongue and groove.

2. Installation methods

Uniclic® is unique as it allows you to install panels in two different ways:

2.1 Method A

Position the panel to be installed at an angle of 20° to 30° to the panel already installed. Move the panel gently up and down and exert forward pressure at the same time. The panels will click into place. This happens as the tongue is inserted into the groove or the groove is pushed onto the tongue. The 'tongue inserted into the groove' is the most common and easiest joining method (see diagrams 1A - 1B - 1C).

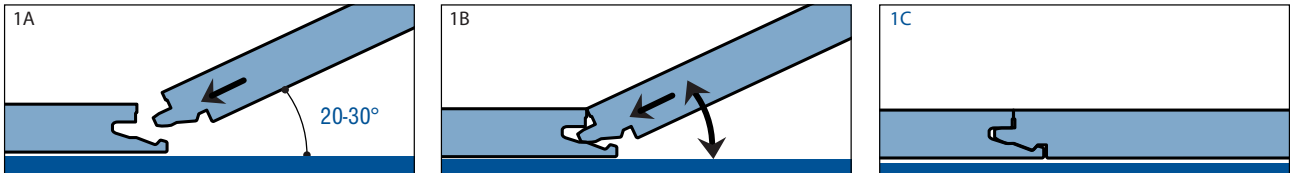

2.2 Method B

With the Uniclic® system, you can also tap the panels into each other without lifting them. This method requires the use of a special Uniclic® tapping block. The panels cannot be joined with a single tap. To avoid damaging the panels, you must tap them together gradually (see diagrams 2A - 2B).

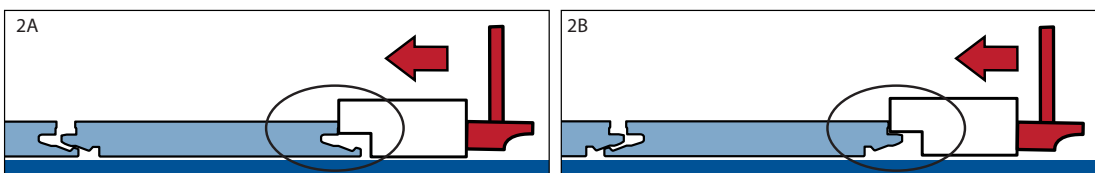

3. Tools for installing the floor

For the best results, it is essential that you strictly follow the installation instructions.

Standard tools for the installation of laminate floors are required:

- Hammer
- Saw
- Pencil
- Measure

In addition, you will also need the following accessories:

- Installation kit (crowbar, wedges or spacers /1 mm to 8 mm/ and Uniclic® adapted tapping block)
- PE film – insulation against moisture
- PE adhesive tape
- Maintenance kit

The use of any accessories other than Uniclic® accessories may cause damage to the FATRACLICK panels. In such case, the warranty provided by FATRA will become void. We therefore advise to use only Uniclic® accessories as these have been specially designed and tested for use with FATRACLICK floor panels.

To obtain a clean cut, the pattern side of panel should face up when you use a jigsaw or lever shears. The pattern side should face down when you use hand saw.

4. FATRACLICK ground rules

1. Thanks to the Uniclic® system, the floor floats and is installed without glue. You can walk on the floor during and immediately after installation.
2. With FATRACLICK you can choose where you want to begin. Think about what will be the easiest way to install the floor. Our example is for right-handed people and the installation proceeds from the left to the right. You can also install the floor in the opposite direction if you want to.
3. Make sure panels are mixed sufficiently before installation so that the various shades and colours are located randomly and the installed floor has a natural look.
4. Check all panels in daylight before and during installation. Defective panels must never be used.
5. If possible, install the floor parallel to the direction in which the light enters the room. The ideal installation conditions are a temperature of 18°C to 22°C and a relative humidity of 50% to 60%.
6. Let the panels acclimatise for 48 hours in the unopened packaging at the normal room temperature, in the middle of the room where the floor is to be installed.
7. As room humidity can vary during the year, it is vital that the floor is able to expand and contract. For this reason, make sure to leave an expansion joint of minimum 8 mm to 10 mm on all sides of the floor, around pipes,

thresholds, under doors and around all fixed/immobile objects (floor ventilation openings, kitchenettes etc).

8. Large rooms must have expansion joints every 13 m both width-wise and lengthwise. It is recommended to build up an expansion joint between two rooms (e.g. under the door). Expansion joints can be finished by means of moulding that is attached to the subfloor.
9. Make sure that the end joints of the panels in two successive rows are never in line. Always ensure that the joints are staggered by at least 10 cm.
10. Make sure that the packs with panels are transported and stored in a horizontal position.

5. Preparing the floor panels

Packed panels and other material used for the application must be allowed to acclimatise for at least 48 hours in the room where they will be installed. The room must be dry and well ventilated. Before installation, check the pattern number, quantity and inspect the boxes and panels for damage. Also check the subfloor and if the room conditions are in accordance with the instructions given in this manual. The temperature and relative humidity during installation and storage must be identical to the conditions under which the floor will be used. The ideal installation conditions are a temperature of 18°C to 22°C and a relative humidity of 50% to 60%. Place the packs and individual panels horizontally on a flat surface (do not, for example, lean them against a wall as the panels may bend).

6. Preparing the room

- Check that the doors can still open and close after the subfloor and the floor have been installed (minimum free space 0,5 cm).
- Remove old moulding.
- Make sure the subfloor is flat. Any unevenness greater than 2 mm over the length of 1 meter must be smoothed out.
- Make sure the subfloor is clean and dry.

The moisture content of the cement-screed base must not exceed approx. 2.0% CM for normal use and approx. 1.8% CM if applied on an underfloor heating system. The moisture content of anhydrite screed must not exceed approx. 0.5% CM for normal use and approx. 0.3% CM if applied on an underfloor heating system. A new concrete floor must dry at least 1 week per 1 cm of floor thickness up to 4 cm. Thicknesses over 4 cm require twice as much drying time. For example, a 6 cm concrete subfloor must dry for at least 8 weeks.

If there is underfloor heating, the subfloor temperature must not exceed 28°C. Before installing the floor, remove any damp-porous floor covering (carpet, needle felt etc). Damp-sealed floor covering (PVC, linoleum etc) does not have to be removed.

If installing the product on a wooden floor, make sure the plank floor is stable. Secure all loose parts and apply a levelling layer if necessary. Install the panels crosswise to the direction of the original floor.

7. Protection against moisture

All types of inorganic screeds require insulation against moisture. Use suitable PE film with a minimum thickness of 0.2 mm. On ground floors and in basements, it is advisable to install two crosswise layers of PE film for better protection against moisture. FATRACLICK floors are not suitable for rooms exposed permanently to high moisture or water steam (showers, saunas etc).

8. Installing the floor

8.1 Floor area

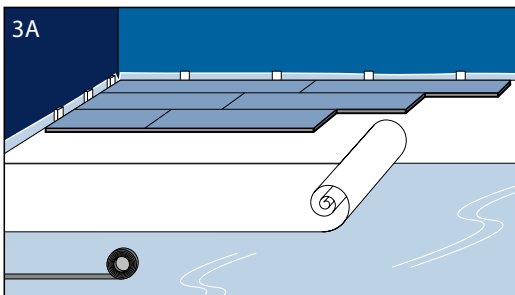

At first lay the PE film on the ground, allowing for at least 20 cm overlapping and seal with a tape. Turn the film upward 5 cm along the walls (see diagram 3A).

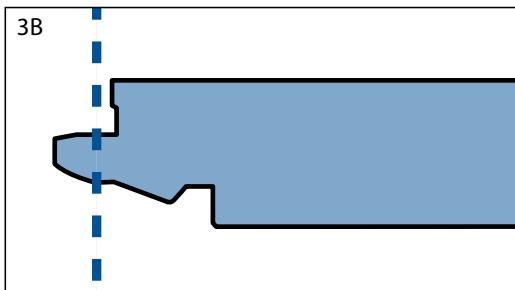

Begin the first row with a whole panel. Make sure to saw off the tongue on both the long and the short side (see diagram 3B).

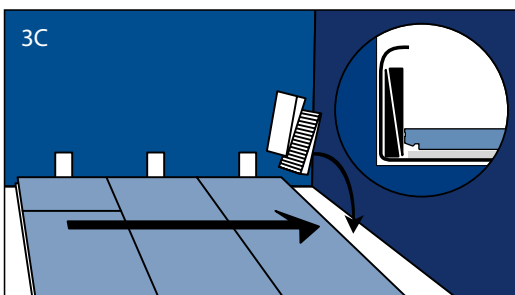

Put the panel with sawn off sides against the wall. Put spacers from the installation kit between the wall and the panels. This will ensure that the expansion joints are wide enough: 8 mm to 10 mm (see diagram 3C).

The diagrams below indicate where the panels are clicked together by lifting up at a certain angle and down or where they are tapped together flat. Make sure to strictly follow the diagram. See diagrams 4.1 to 4.16.

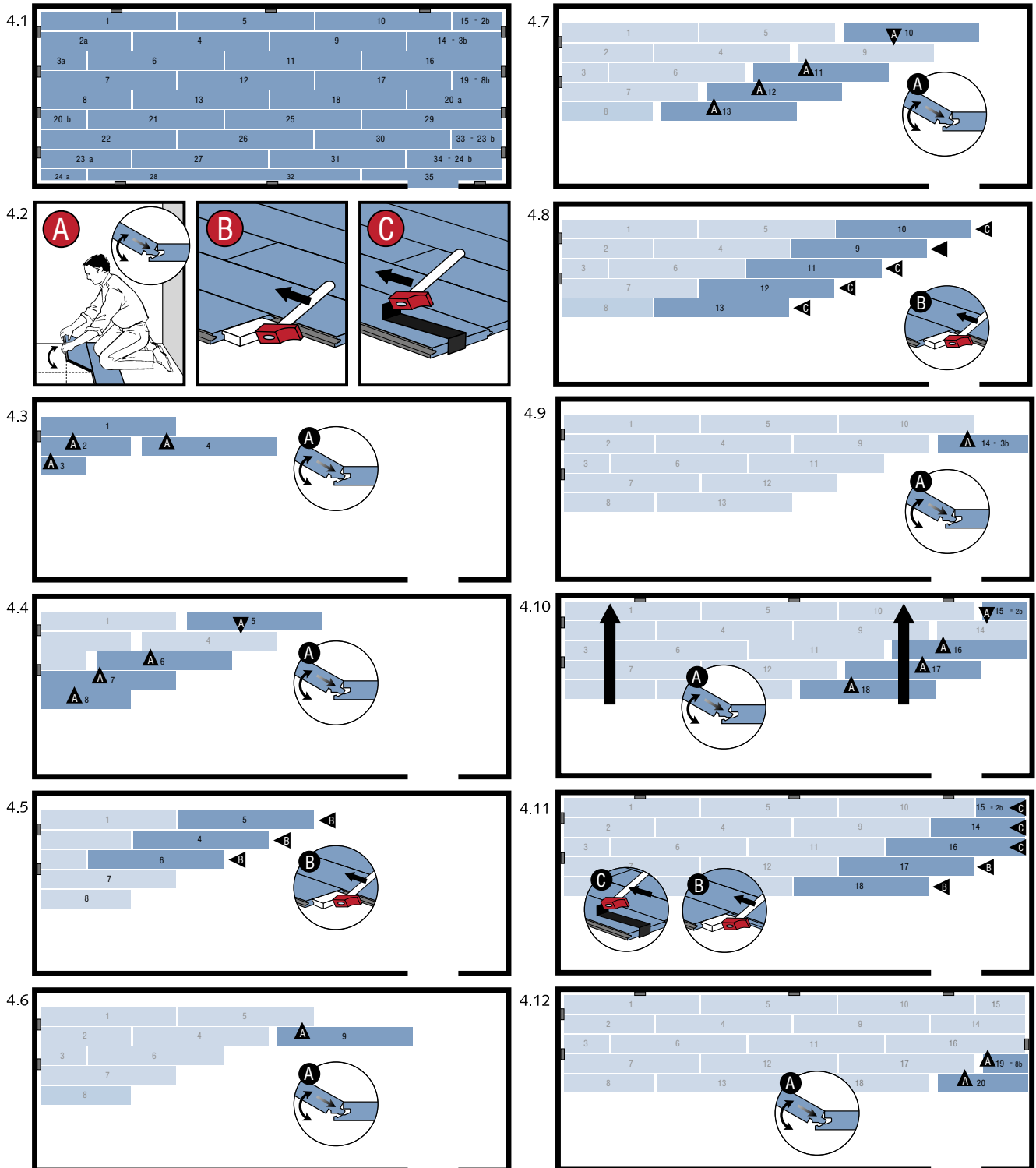

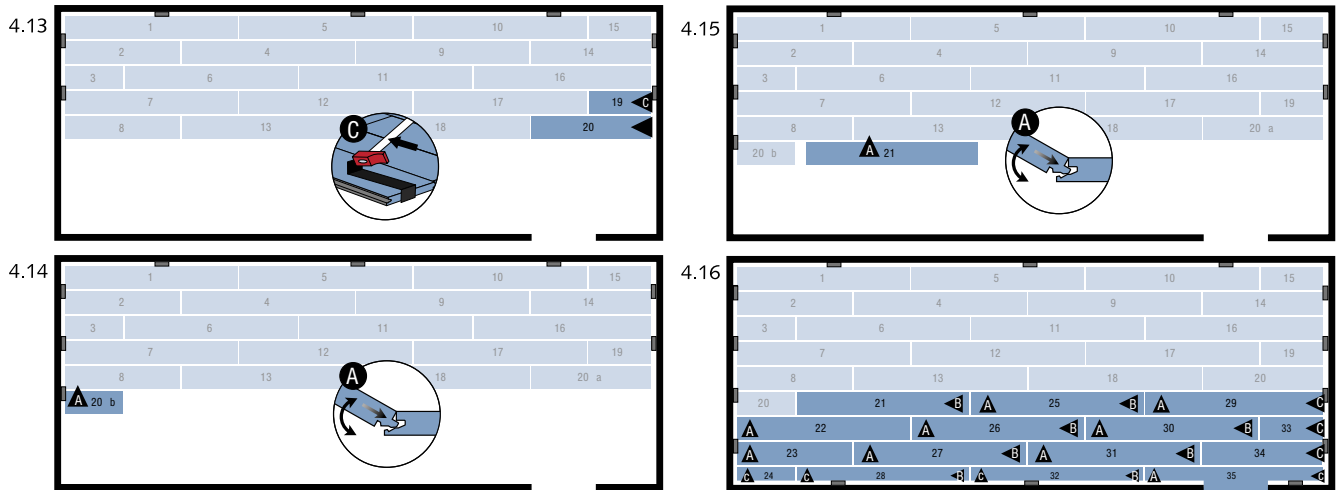

In places where it is too difficult to install the panels with the tapping block (e.g. against a wall), you can tap the panels together using the crowbar and a hammer (see diagrams 5A - 5B - 5C.)

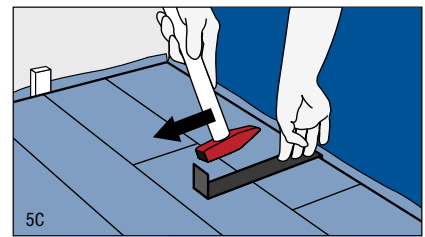
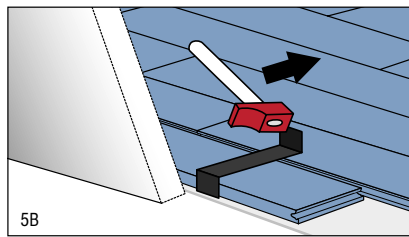
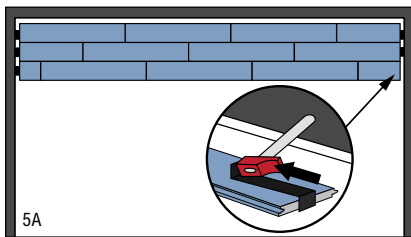

There must also be an 8 mm to 10 mm expansion joint between the last row and the wall. Keep this in mind when sawing the last row of panels.

8.2 Around pipes

In rows where there is a pipe, make sure the pipe falls exactly in line with the shorter side of two panels. Take a drill bit with the same diameter as the pipe plus 20 mm (3/4") (expansion joint). Click the panels together on the short side and drill a hole centred on the joint between the two panels. Now you can install the panels on the floor. See diagrams 6A-6B-6C.

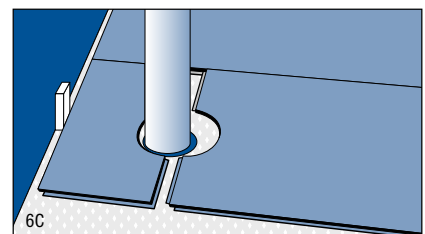
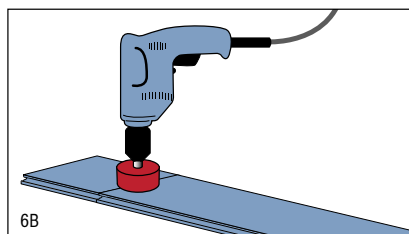
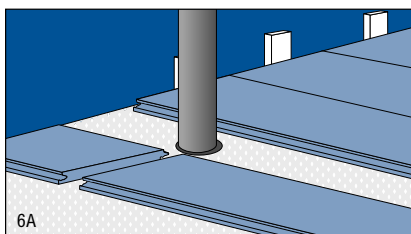

8.3 Under doorframes

Ensure that the expansion joint under the door is 8 mm to 10 mm. Cover the joint with a threshold or moulding. The moulding above the expansion joint must be secured so that it does not prevent the movement of the floor panels. It is advisable to cut wooden doorframes by the height of the floating floor and base materials so that the floor can expand and the floor panels end under the casing. If you cannot lift the panel, use the adapted tapping block and a hammer to tap the panels together while they lie flat on the floor. See diagrams 7A-7B.

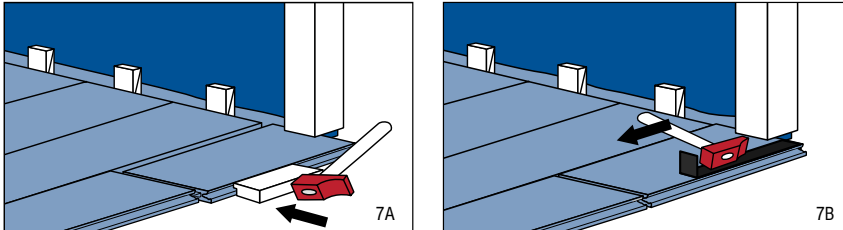

If the doorframe cannot be shortened, e.g. steel doorframe, make sure to seal the edge gaps. The sufficient width of gaps around doorframes is then 3 mm to 5 mm.

8.4 Finishing

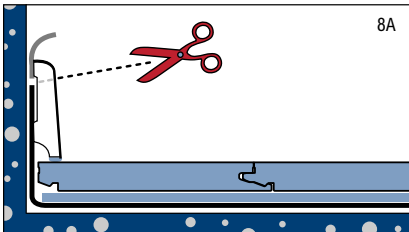

- Remove all spacers.
- Install the moulding and rosette.

Never attach the moulding to the floor. This method allows the floor to expand and contract under the moulding. For a perfect finish of the floor around pipes, use rosettes or caulking. In places where profiles or skirting cannot be placed, fill expansion gaps with caulking (see diagram 8A).

8.5 Installation on an underfloor heating system

The FATRACLICK floor may also be installed on an underfloor heating system. Specific operating conditions apply to each underfloor heating system, depending on the system and the subfloor. In order to avoid malfunctions, it is essential to strictly follow all standards and instructions given by the heating system manufacturer.

Before installation, the floor heating system must be on for 10 days at a temperature of 25°C to 30°C to ensure the subfloor is sufficiently dry. The surface temperature during installation must not exceed 18°C and must remain such for 3 days after installation completion. After the underfloor heating system is switched on, its temperature must be increased in steps and must not exceed 28°C on the subfloor surface.

9. Care and maintenance

The FATRACLICK floor is coated with a layer of PUR lacquer that protects it against the ingress of dirt and makes maintenance easier. After installation, it is sufficient to clean the floor with a moist mop and a cleaner suitable for PVC floors with a protective PUR layer. No additional lacquering or waxing is necessary. In specific cases where the floor is exposed to heavy use or where extreme maintenance is required, we recommend applying an additional protective PUR layer of a suitable vinyl floor protection product.

The durability of the FATRACLICK floor depends on both the intensity of use and the quality of care and maintenance. Use only products suitable for PVC with a PUR layer. Make sure to follow the instructions of the cleaning product manufacturer and contact its technical specialists if necessary.

Do not use any aggressive products for standard cleaning (e.g. conventional detergents, products containing abrasives and alkali or products with a high content of organic solvents and degreasing substances).

Dust and dirt have the same effect as sandpaper and may damage your floor. Remove dust and dirt manually, using a suitable process (sweeping or vacuum cleaning) and tools (dry sweep mop, vacuum cleaner). For routine cleaning, use a dry or humid cloth only and suitable neutral cleaners.

Wet cleaning is forbidden!

Post-installation precautions

- If other works are to be performed in the room after the floor installation, protect the floor against damage.
- Do not pull any furniture along the floor.
- Use suitable protective products on contact surfaces with the floor (e.g. textile pads under chair and table legs or PET boards under rolling chairs).
- Take effective measures against the ingress of dirt (use doormats).
- Also make sure to check and clean protective products on a regular basis.
- Rubber products (usually dark and coloured rubber – rubber wheels, machine guards, footwear soles etc) tend to cause an irreversible colour change to the top layer of the floors.
- Do not expose the floor, and in particular the joints of the panels, to moisture and water.
- Remove any spillages immediately.
- Ensure optimal humidity at approx. 50%. If necessary, use air humidifiers.
- Prevention is the best way to maintain the functionality of the floor. Once the first wear marks appear, it is advisable to renew the original PUR finish by applying a suitable product (PUR protective layer).
- Do not use forklift and pallet trucks on the floor.

If the PUR protective layer is scratched by mobile furniture whose contact points with the floor are not protected with suitable protective products, such scratches are not covered by warranty.

If you have any questions about the FATRACLICK floor, do not hesitate to contact our Insulation Studio. The staff will be happy to give you advice regarding the product suitability, parameters and installation. A new department of Fatra, a.s. Napajedla, the Insulation Studio focuses on providing technical support to contractors, construction companies, architects and investors.

Name: Installation Specification for FATRACLIC Floor Elements
Issuer: Fatra a. s., Napajedla
Number of printed copies: 200 pcs
Issue date: June 2011



The installation specification's actual version is available on the following website:
www.fatrafloor.cz

fatra

Fatra, a.s., tř. T. Bati 1541, 763 61 Napajedla, Czech Republic
Tel.: +420 577 501 111, e-mail: podlahy@fatra.cz, www.fatrafloor.cz, www.fatra.cz